

# Progetto V1 - Monte San Savino, Le fornaci (AR)

Stato attuale

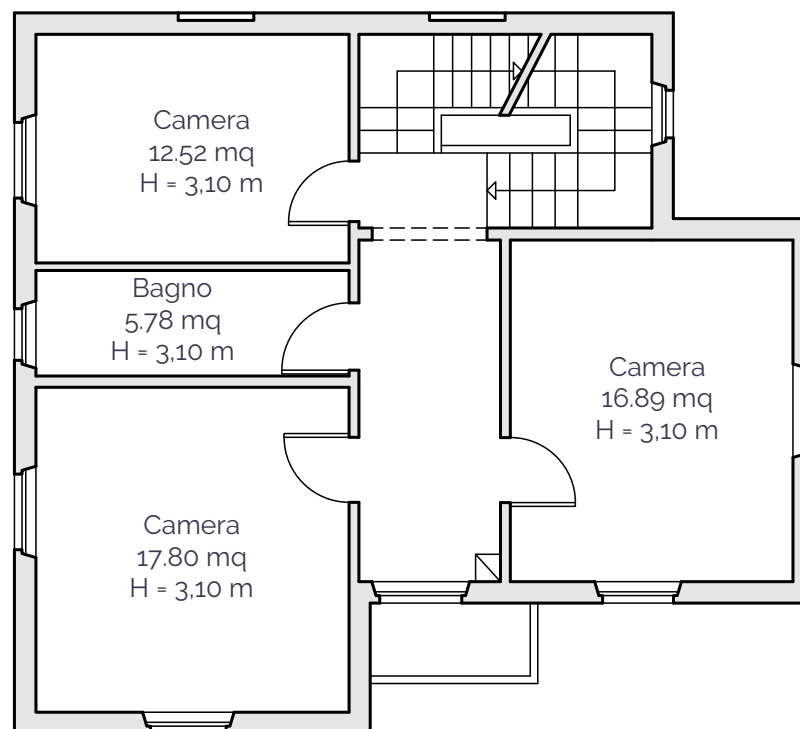

Piano primo

Sup. netta: 61,45 mq

Sup. lorda: 86,65 mq

**HOOMI**

# Progetto V1 - Monte San Savino, Le fornaci (AR)

Stato attuale

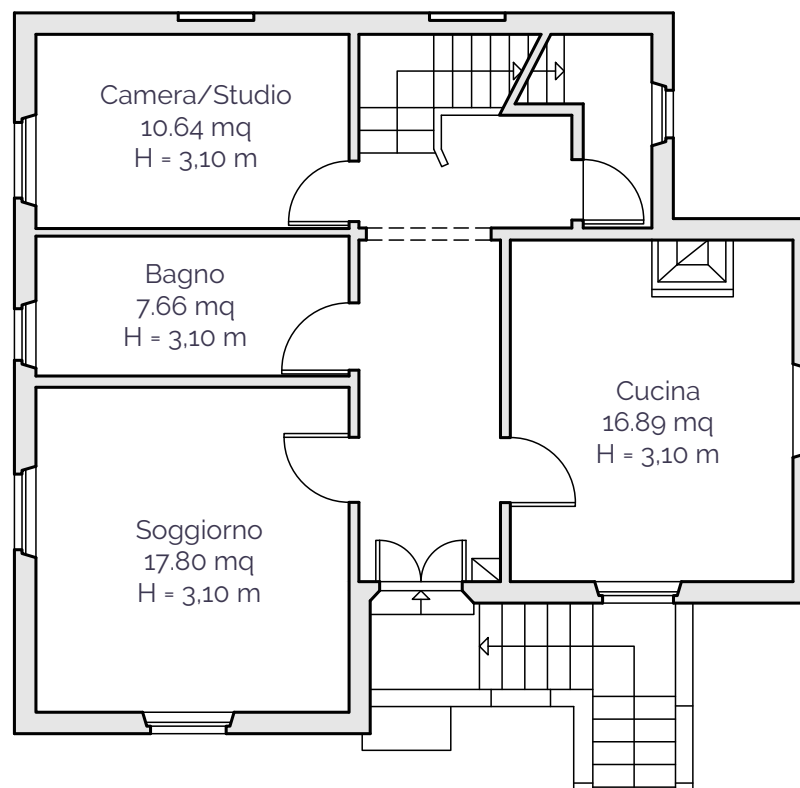

**Piano rialzato**

**Sup. netta: 61,45 mq**

**Sup. lorda: 86,65 mq**

**HOOMI**

# Progetto V1 - Monte San Savino, Le fornaci (AR)

Stato attuale

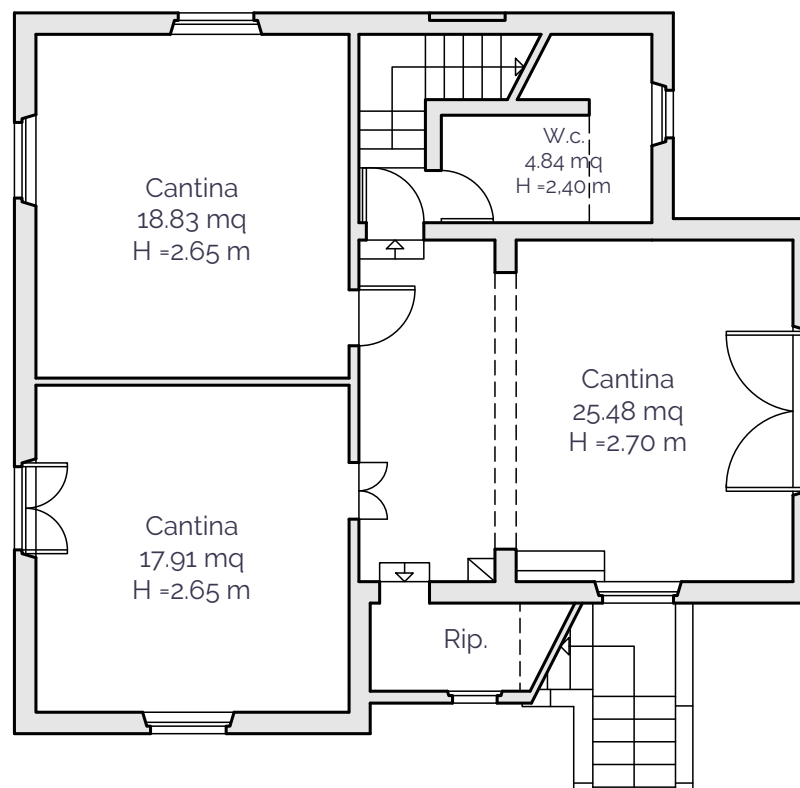

Piano seminterrato  
Sup. netta: 71,12 mq  
Sup. lorda: 86,30 mq